

\$615,000 - 23 Belgian Court, Cochrane

MLS® #A2184737

\$615,000

3 Bedroom, 3.00 Bathroom, 1,661 sqft
Residential on 0.08 Acres

Heartland, Cochrane, Alberta

****Under Construction **** Open House at
Greystone showhome - 498 River Ave,
Cochrane - Apr. 17th 3:30-5:30pm, Apr. 19th
1-4pm, Apr. 20th 1-4pm and Apr. 21st 12-4pm

****** Welcome to the pinnacle of contemporary living in the Easton Model, a 1661 sqft haven with 3 bedrooms and 2.5 baths. The open-concept main floor bathes in natural light, featuring 9-foot ceilings and expansive triple-pane windows that illuminate the gourmet kitchen's sleek quartz countertops. Convenience meets style with a walk-in pantry, and the double attached garage ensures direct access to this modern retreat. Beyond its aesthetic charm, the Easton Model offers a bonus room on upper level and unfinished basement, making it the perfect home that seamlessly combines luxury with functionality. Welcome to the Easton Model where thoughtful design creates a truly exceptional place to call home.

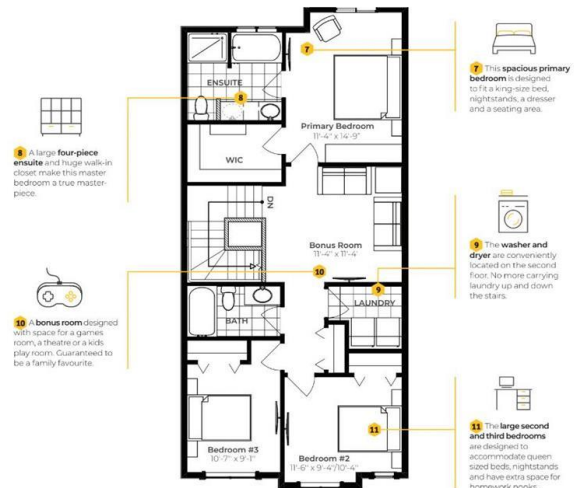
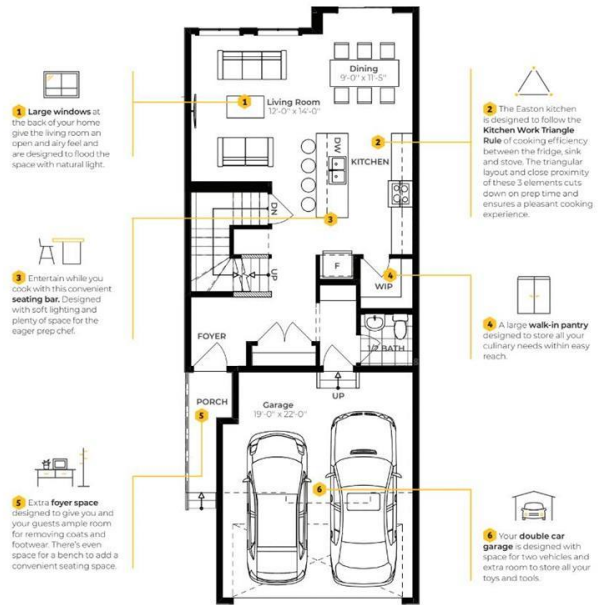

Built in 2024

Essential Information

MLS® #	A2184737
Price	\$615,000
Bedrooms	3
Bathrooms	3.00
Full Baths	2
Half Baths	1
Square Footage	1,661



Acres	0.08
Year Built	2024
Type	Residential
Sub-Type	Detached
Style	2 Storey
Status	Active

Community Information

Address	23 Belgian Court
Subdivision	Heartland
City	Cochrane
County	Rocky View County
Province	Alberta
Postal Code	T4C 0M2

Amenities

Parking Spaces	2
Parking	Double Garage Attached
# of Garages	2

Interior

Interior Features	Built-in Features, High Ceilings, Kitchen Island, No Animal Home, No Smoking Home, Open Floorplan, Quartz Counters, Walk-In Closet(s)
Appliances	Dishwasher, Microwave, Refrigerator, Stove(s), Washer/Dryer
Heating	Forced Air
Cooling	None
Has Basement	Yes
Basement	Full, Unfinished

Exterior

Exterior Features	Other
Lot Description	Back Lane
Roof	Asphalt Shingle
Construction	Stucco, Wood Frame
Foundation	Poured Concrete

Additional Information

Date Listed	December 31st, 2024
Days on Market	108

Zoning TBD

Listing Details

Listing Office eXp Realty

Data is supplied by Pillar 9â„¸ MLSÂ® System. Pillar 9â„¸ is the owner of the copyright in its MLSÂ® System. Data is deemed reliable but is not guaranteed accurate by Pillar 9â„¸. The trademarks MLSÂ®, Multiple Listing ServiceÂ® and the associated logos are owned by The Canadian Real Estate Association (CREA) and identify the quality of services provided by real estate professionals who are members of CREA. Used under license.